

形状・寸法 / 特性

Shapes and dimensions/Characteristics

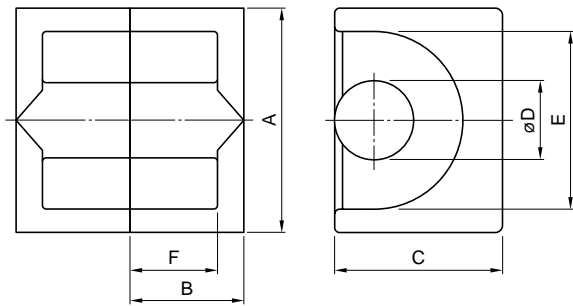

形状 Type	通称 Alias	寸法 Dimensions(mm)							
		A	2B	B	C	øD	E	2F min.	F
EEP-7D	EP7	9.20±0.20	7.40	3.70±0.05	6.35±0.15	3.30±0.10	7.40±0.20	5.00	2.60±0.10
EEP-10D	EP10	11.5±0.3	10.2	5.10±0.10	7.65±0.20	3.30±0.15	9.40±0.20	7.20	3.70±0.10
EEP-13D	EP13	12.5±0.3	12.85	6.425±0.075	8.80±0.20	4.35±0.15	10.0±0.3	9.00	4.60±0.10
EEP-17D	EP17	18.0±0.4	16.8	8.40±0.10	11.0±0.25	5.68±0.18	12.0±0.4	11.0	5.65±0.15
EEP-20D	EP20	24.0±0.5	21.4	10.7±0.1	14.95±0.35	8.75±0.25	16.5±0.4	14.0	7.15±0.15

形状 Type	通称 Alias	AL value(nH/N <sup>2</sup> )±25%					コア定数 Core parameters					Weight (g/set)
		MB3	MB4	MA055* <sup>1</sup>	MA100* <sup>1,2</sup>	MA150* <sup>1,2</sup>	C <sub>i</sub> (mm <sup>-1</sup> )	Le(mm)	Ae(mm <sup>2</sup> )	Amin(mm <sup>2</sup> )	Ve(mm <sup>3</sup> )	
EEP-7D	EP7	1220	1220	1750	4120min.	5290min.	1.42	15.2	10.7	8.55	164	1.5
EEP-10D	EP10	1140	1140	1690	3760min.	4920min.	1.66	18.8	11.3	8.55	214	2.8
EEP-13D	EP13	1600	1600	2420	5440min.	7280min.	1.21	23.7	19.6	14.9	463	4.7
EEP-17D	EP17	2420	2420	3670	8330min.	11200min.	0.816	27.7	33.9	25.3	939	12.3
EEP-20D	EP20	4320	4320	6850	14700min.	20300min.	0.493	38.8	78.7	60.1	3060	29.2

\*<sup>1</sup>See page 26 for material characteristics.

\*<sup>2</sup>Mirror like surface lapping.